



# Board Presentation

Construction Division

February 28, 2024

**SEE THE IMPACT**



# Who we are:



## Construction Services

**Thomas Plapp**

Fixed Asset Clerk 29 yrs

**Albert Valadez**

Environmental Specialist 22 yrs

**Joe Carreon**

Construction Director 6 yrs





# Division Goal

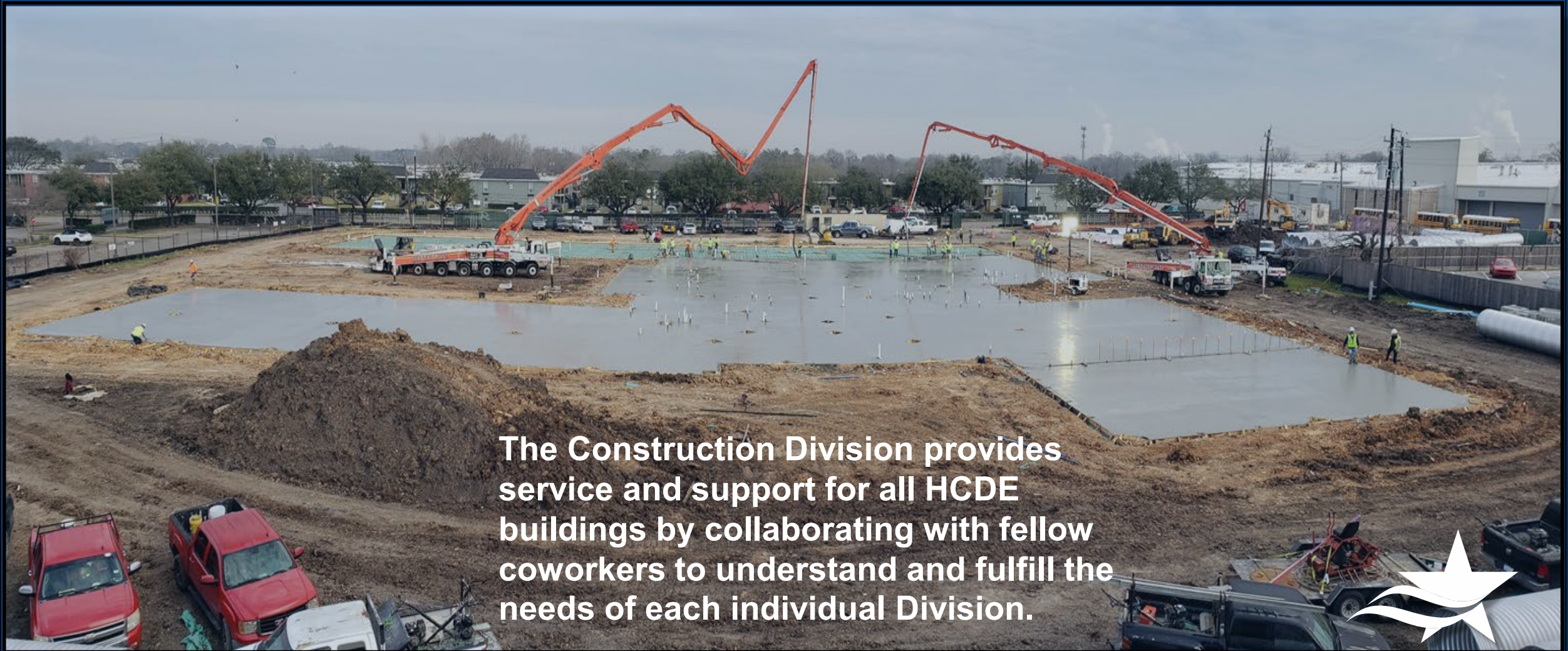

The Construction Division provides service and support for all HCDE buildings by collaborating with fellow coworkers to understand and fulfill the needs of each individual Division.



# What we do:

## **Fixed Assets Clerk:**

- Performs Annual Capital Inventory.
- Maintain records of fixed assets transactions.

## **Environmental Specialist:**

- Performs fire and safety inspections on all HCDE buildings.
- Performs inspections on playgrounds and ropes course.

## **Construction Director:**

- Liaison to architects, engineers, and consultants to develop and finalize construction plans and specifications.
- Assist with land acquisition, appraisals, & environmental reports.





# Completed Projects

2020 Bond	Construction Cost	Soft Costs	Furniture	Total	Students	Classrooms
Adult Education Center	\$14,917,107.00	\$ 2,252,316.35	\$ 940,545.86	\$18,109,969.21	502	24
High Point East MS	\$ 7,271,000.00	\$ 995,471.57	\$ 241,107.22	\$ 8,507,578.79	140	9
ABS East	\$12,348,500.00	\$ 742,256.00	\$ 477,915.93	\$13,568,671.93	184	23

## Department of Health Human Services Early Head Start Expansions

Barrett Station EHS	\$ 1,960,535.21	\$ 111,548.60	\$ 64,000.00	\$ 2,136,083.81	51	4
Humble EHS	\$ 1,755,937.26	\$ 73,646.00	\$ 64,000.00	\$ 1,829,583.26	45	4

## Department of Health Human Services Disaster Recovery

Coolwood Head Start 80%	\$ 7,759,086.16	\$ 629,065.95	\$ 190,567.04	\$ 8,578,719.15	120	6
Land Acquisition 2020	\$ 587,215.00					

# Current Projects

2020 Bond	Construction Cost	Soft Costs	Furniture	Total	Students	Classrooms
Admin Building Rehab	\$12,001,964.20	\$ 952,492.00	\$ 1,516,131.08	\$14,470,587,28		
Department of Health Human Services Disaster Recovery Funds						
Coolwood Head Start 90%	\$ 7,759,086.16	\$ 629,065.95	\$ 190,567.04	\$ 8,578,719.15	120	6
Land Acquisition 2020	\$ 587,215.00					

# Completed Project: Adult Education Center





# Completed Project: Adult Education Center





# Completed Project: Adult Education Center





# Completed Project: Adult Education Center





# Completed Project: Adult Education Center



# Completed Project: Adult Education Center





# Completed Project: Adult Education Center

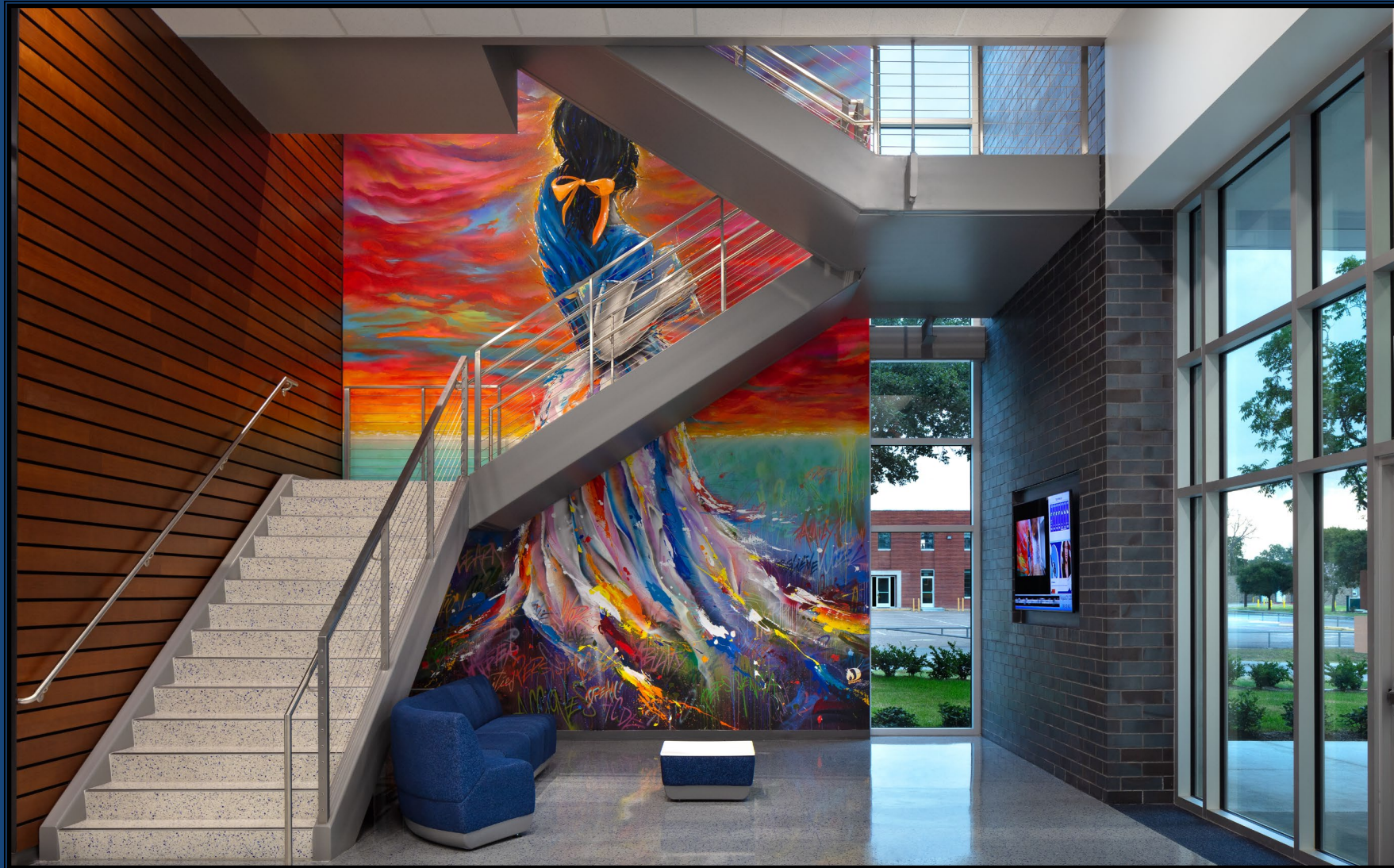



# Completed Project: Adult Education Center





# Completed Project: Adult Education Center





# Completed Project: ABS East





# Completed Project: ABS East





# Completed Project: ABS East





# Completed Project: ABS East





# Completed Project: ABS East



# Current Project: ABS East





# Completed Project: ABS East



# Completed Project: ABS East





# Completed Project: ABS East





# Completed Project: ABS East





# Completed Project: ABS East





# Completed Project: High Point East Middle School





# Completed Project: High Point East Middle School



# Completed Project: High Point East Middle School



**HIGHPOINT**  
COURAGE • CONFIDENCE • COMMITMENT





# Completed Project: High Point East Middle School





# Completed Project: High Point East Middle School



**HIGHPOINT**  
COURAGE • CONFIDENCE • COMMITMENT





# Completed Project: High Point East Middle School





# Completed Project: Humble Early Head Start





# Completed Project: Humble Early Head Start





# Current Project: Coolwood Head Start



<https://youtu.be/7FN9ikO7PzA>





# Current Project: Coolwood Head Start





# Current Project: Coolwood Head Start





# Current Project: Administration Building Renovation





# Current Project: Administration Building Renovation





# Current Project: Administration Building Renovation





# Current Project: Administration Building Renovation



cre8  
ARCHITECTS





# Current Project: Administration Building Renovation



**cre8**  
ARCHITECTS





# Current Project: Administration Building Renovation





# Current Project: Administration Building Renovation





# Trends 2022

**Figure 1**

**PPIs for construction bid prices and selected inputs**  
cumulative change in PPIs, April 2020-June 2022 (not seasonally adjusted)

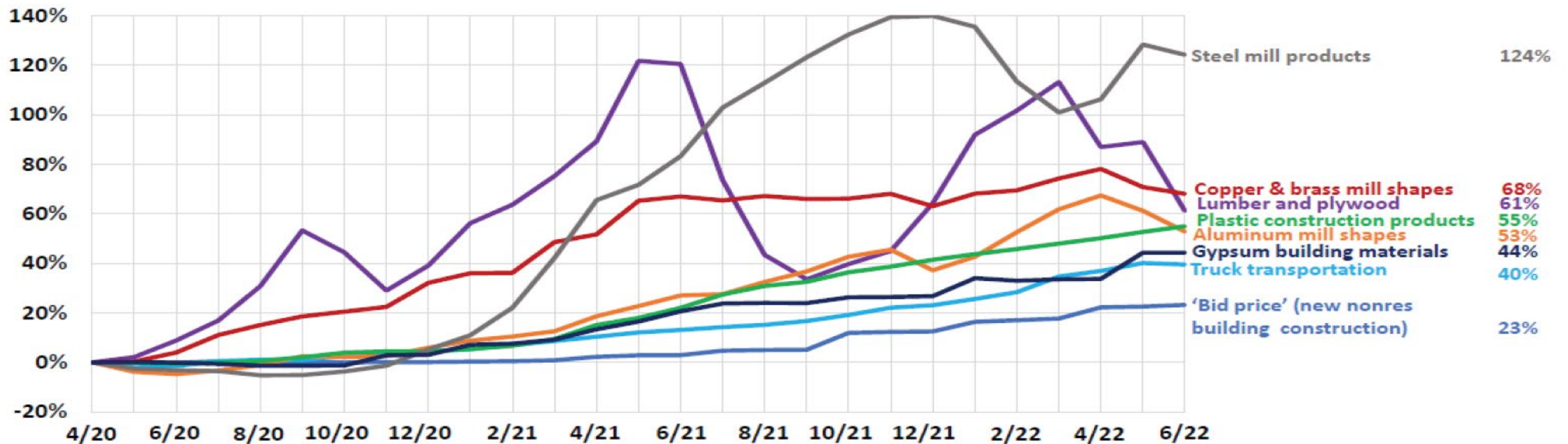

Source: Bureau of Labor Statistics, producer price indexes, [www.bls.gov/ppi](http://www.bls.gov/ppi)

Source: Bureau of Labor Statistics, Producer Price Indexes, [www.bls.gov/ppi](http://www.bls.gov/ppi)

# Trends 2023

## UNADJUSTED 12- MONTH PERCENTAGE CHANGE

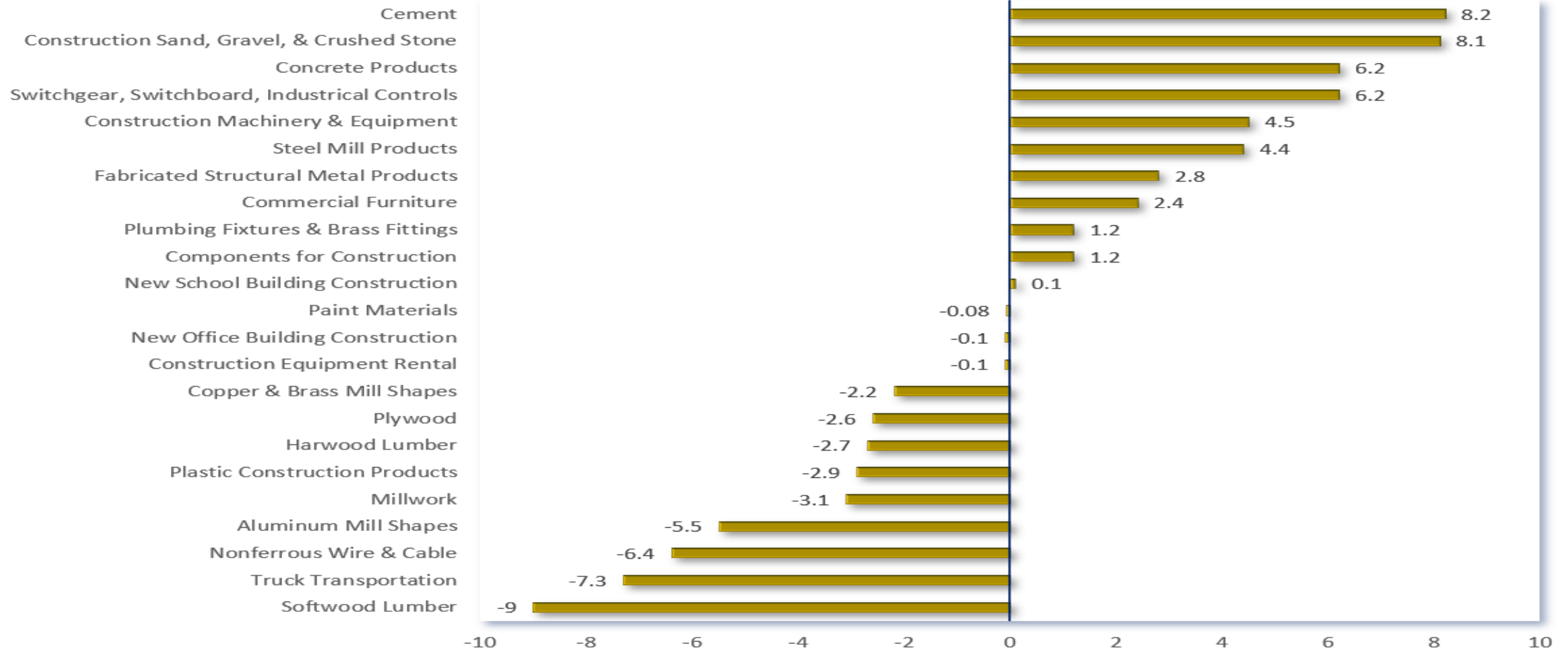

Source: Bureau of Labor Statistics, Producer Price Indexes, [www.bls.gov/ppi](http://www.bls.gov/ppi)



# Trends 2023

## Construction Cost Trends 2021-2023

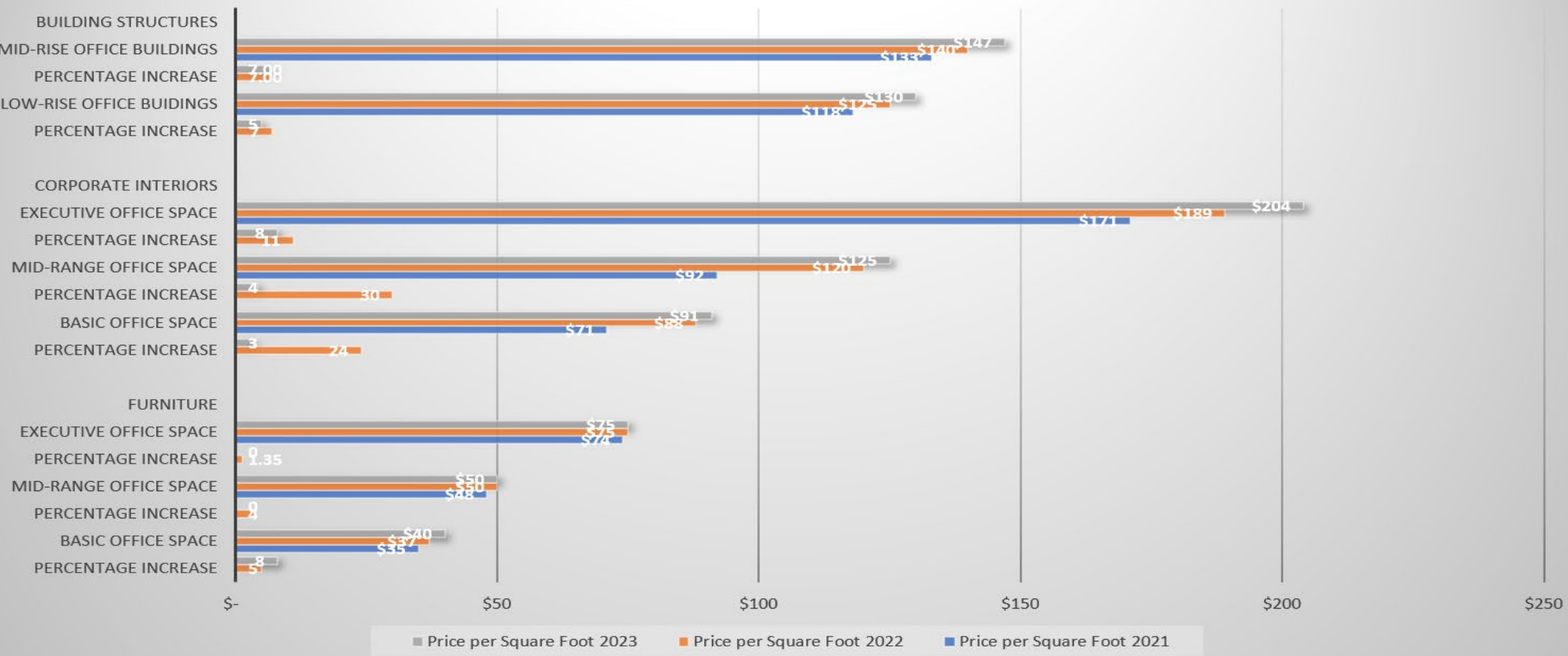

# Trends 2024

- For the first time in more than two decades, the U.S. last year bought more goods from Mexico than China.
- US Steel, once the world's largest corporation, agrees to sell itself to a Japanese company
- US involved in multiple proxy wars.
- By 2027 worldwide AI-related electricity consumption could increase by 85%.
- EV Charging Stations will also lead to more electricity consumption.
- The Infrastructure Investment and Jobs Act was signed into law on November 15, 2021. The law authorizes \$1.2 trillion for transportation and infrastructure spending with \$550 billion of that figure going toward "new" investments and programs.





# Trends 2024

## Preferred Procurement Method

- **CMaR** method awards the contract to the General Contractor during the design process.
  - This allows the GC to give real-time cost estimates and help adjust materials, equipment, and finishes to meet the budget.
  - Also allows the owner to order equipment before the plans have been finalized.

